

LS21 Chard Fitting Instructions

Read all instructions before starting installation

Fitting into a pier being built

- Build the pier up as shown in *Figs 1, 2 and 3*.
- Note the orientation of the chute (*C*), the top protrudes 5mm further than the bottom.
- Locate the chute (*C*) through the access hole so that the bottom of the chute finishes 5mm in from the front face of the brickwork. *Fig 4*. (The top of the chute protrudes 5mm further than the bottom). Place a bead of silicon around the joint to seal.
- Build the remainder of the pier. When set, use silicon to fill any gaps. *Continued*

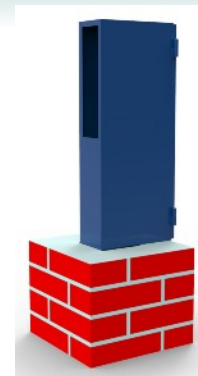

Fig 1

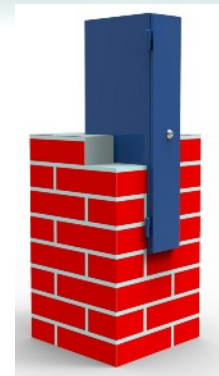

Fig 2

Fitting into an existing pier

- Cut a hole 293mm high by 82mm wide at the required location for the letter plate in the front of the pier. This allows a 2mm tolerance around the chute. *Fig 5*.
- Cut the container hole at the rear of the pier 606mm high by 114mm wide in line with the chute hole at the front. This allows a 2mm tolerance around the container. The bottom of the container hole should start 297mm below the bottom of the chute hole. This should be approximately 4 courses of standard metric bricks. *Fig 6*.
- Note the orientation of the chute (*C*), the top protrudes 5mm further than the bottom.
- With the aid of an assistant position the container (*D*) and chute (*C*) into their respective holes. They will need to be bedded in with silicon or similar. Align the top of the chute to the front face of the brickwork
- From the inside of the collection box, seal the gap between the chute and container with silicon.

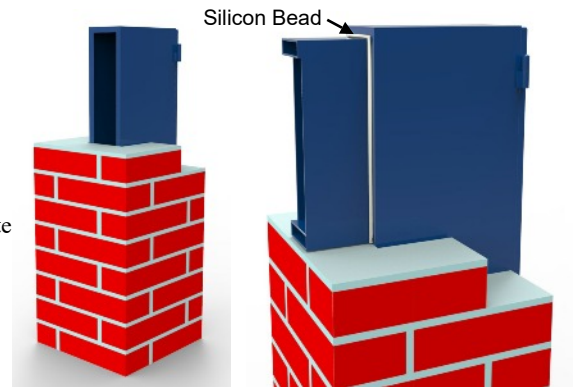

Fig 3

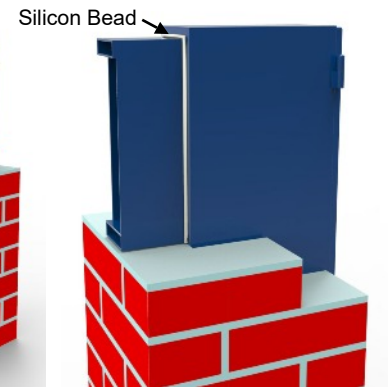

Fig 4

Instructions Continued

- Lightly turn the 2 studs (*B*) into the letter plate (*A*) and locate into place through the chute. Note the orientation of the letter plate, the spring should be on the left hand side.
- With the aid of an assistant, keep the letter plate in place and from the inside of the collection box, locate the brackets (*E*) over the studs and secure into place using the washers (*F*) and nylocs (*G*). Do not over tighten the nylocs. *Figs 7 & 8*.
- Using clear silicon, seal around top and sides between the letter plate and brick face. Do not seal the bottom.

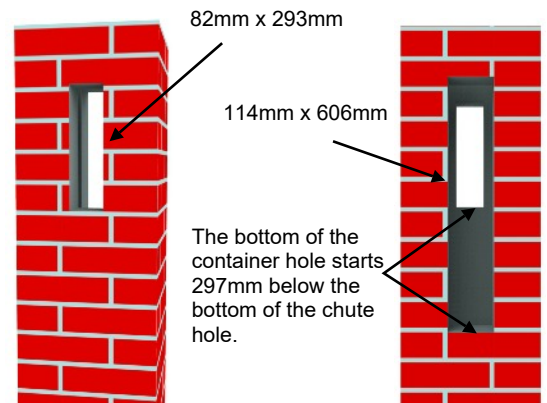

Fig 5

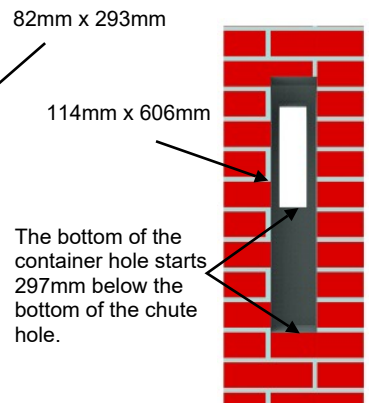

Fig 6



Fig 7

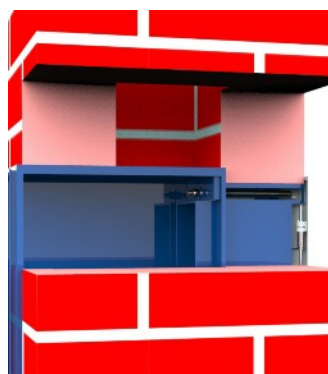
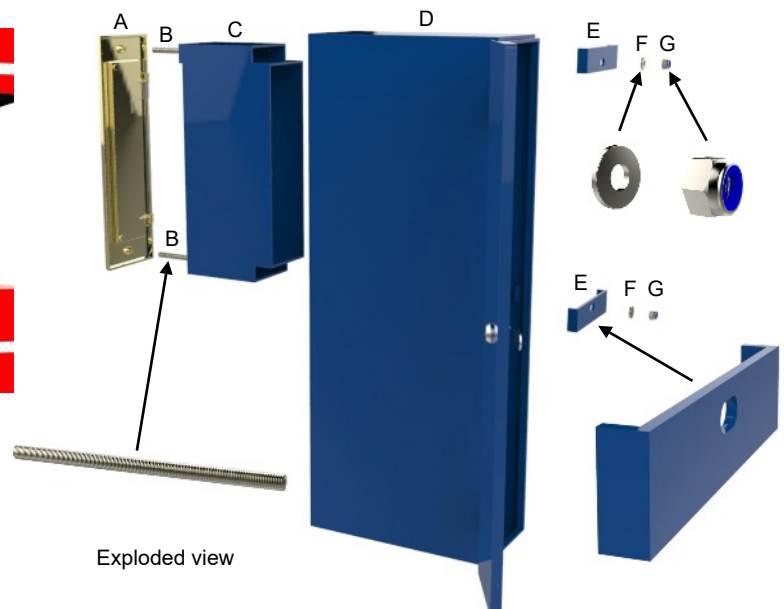

Fig 8 (Section)



Exploded view